



ASSEMBLY INSTRUCTION

NP*XX Series | Professional 1/4" Plugs

1 CABLE & BOOT ASSEMBLY

Ⓐ



Ⓐ Slide the boot onto the cable.

2 PREPARE CABLE

Ⓐ

Wire size: max. 1.0 mm² / 18 AWG
Cable O.D.: 4.0 - 7.0 mm [0.16-0.28"]

Prepare cable as shown.

Ⓑ

NP2XX

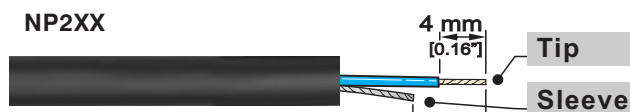

Ⓐ Cable size information.

Ⓑ 2 pole plug cable preparation .

Ⓒ

NP3XX

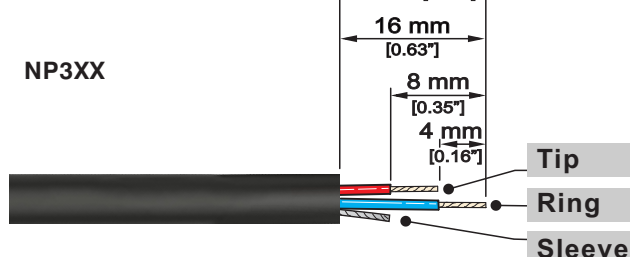

Ⓒ 3 pole plug cable preparation .

3 SOLDER CABLE

Ⓐ

NP2XX

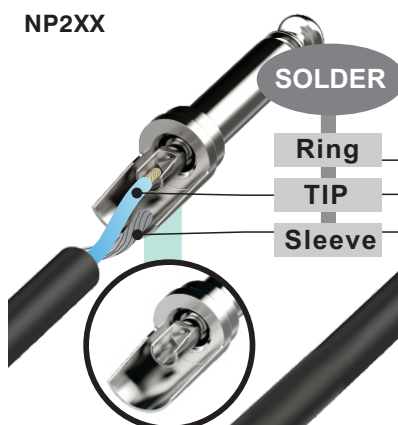

Ⓑ

NP3XX

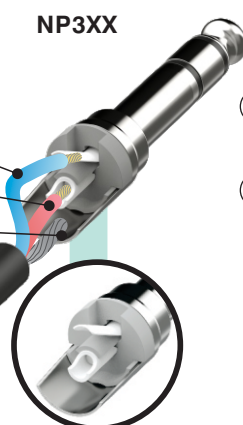

Solder the wire ends.

Ⓐ 2 pole with Tip & Sleeve

Ⓑ 3 pole with Ring, Tip & Sleeve



4 INSERT & HOUSING ASSEMBLY

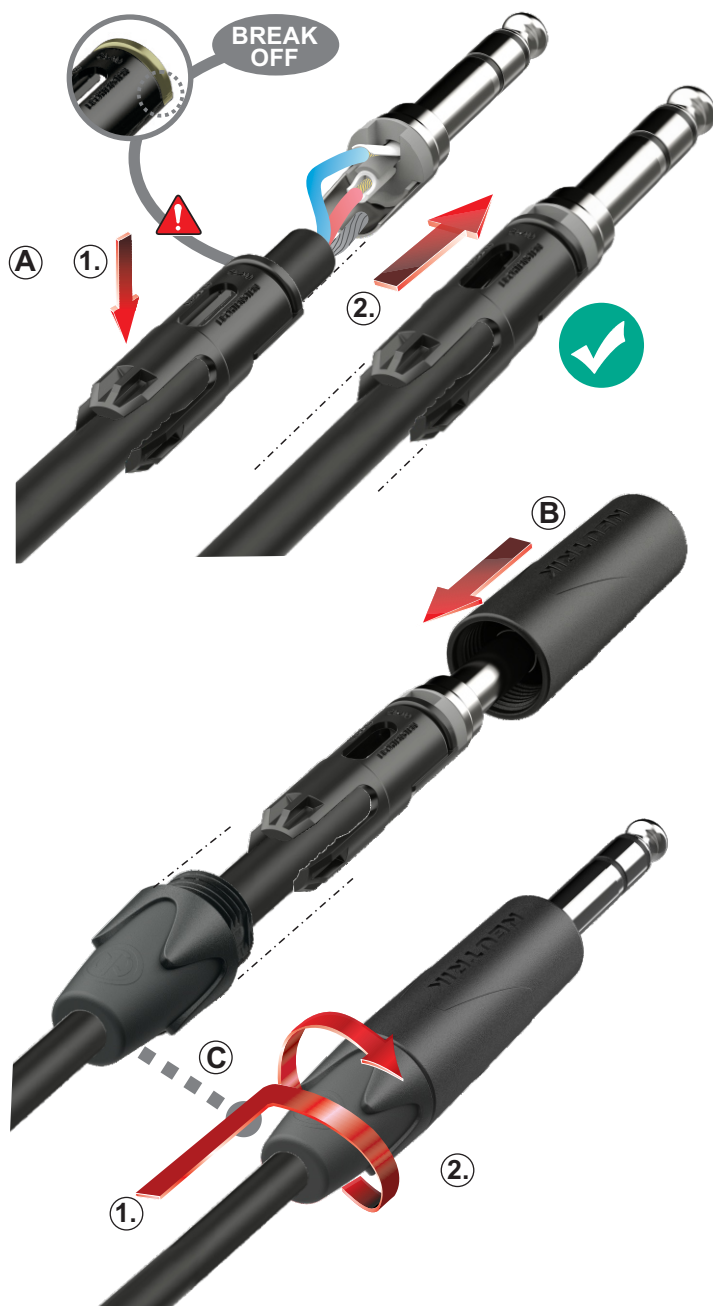

- A** Position the chuck onto the cable (1) and align chuck with plugfinger (2).

⚠ Attention:

If using a cable with O.D. > 5.50 mm [0.216"] break away this part of the chuck.

- B** Slide the housing onto the plugfinger with the chuck.

- C** Finish the installation (1) by tighten the bushing (2) onto the connector.



FINISHED XX PLUG



FINISHED PLUG CONNECTOR

i More Information on the website

<https://www.neutrik.com/en/neutrik/products/plugs-jacks/plugs/professional-1-4-plugs>



Draft. Nr.: BDA 713 V2
Update: 2025-05-21

Neutrik AG | LI-9494 Schaan
www.neutrik.com

Data subject to change without prior notice. © 2025 NEUTRIK®, NEUTRIK® are registered trademark of Neutrik AG. ALL RIGHTS RESERVED.